

MODEL 450

SIDE LOAD

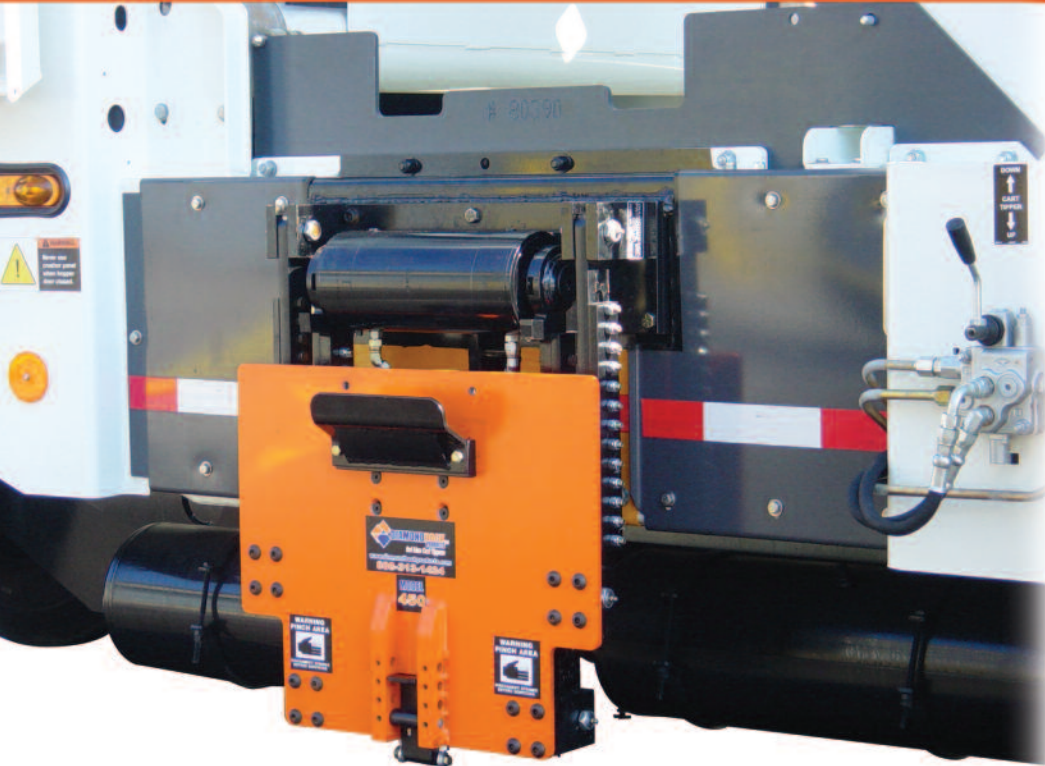

- **Eliminates Bottom Bar Cart Damage**
Patented spring bottom bar latching system virtually eliminates bottom bar damage by providing shock absorption during dump cycle and also ensures above ground release.
- **High/Deep Dump**
Cart lifter gives a high/deep throw into hopper allowing for speed of emptying carts. This also provides a deep enough dump for side load trucks used in dual stream recycling programs.
- **Heavy Duty Lifting and Drive Arms**
3/4" solid steel lifting and drive arms. This is the only side load cart lifter with adjustable arms that makes installation possible for most truck mounting heights.
- **Self-Aligning Ball Bushings**
Made of hardened steel, shock and corrosion resistant, and require very low lubrication maintenance.
- **26K Rotary Actuator**
The largest actuator used in the lifter industry. Actuator shaft is designed with splined ends and matching collar, *not keyways*, to provide increased life. Actuator produces 26K ft/lb of torque at 3000 psi.

Diamondback 3rd Man Tippers are engineered with fewer moving parts for longer life, easier maintenance, and to save you money on parts inventory.

Simple is Better.



888-313-1424 • www.diamondbackproducts.com

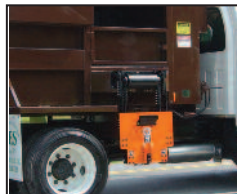

CLEARANCE AND DIMENSIONS

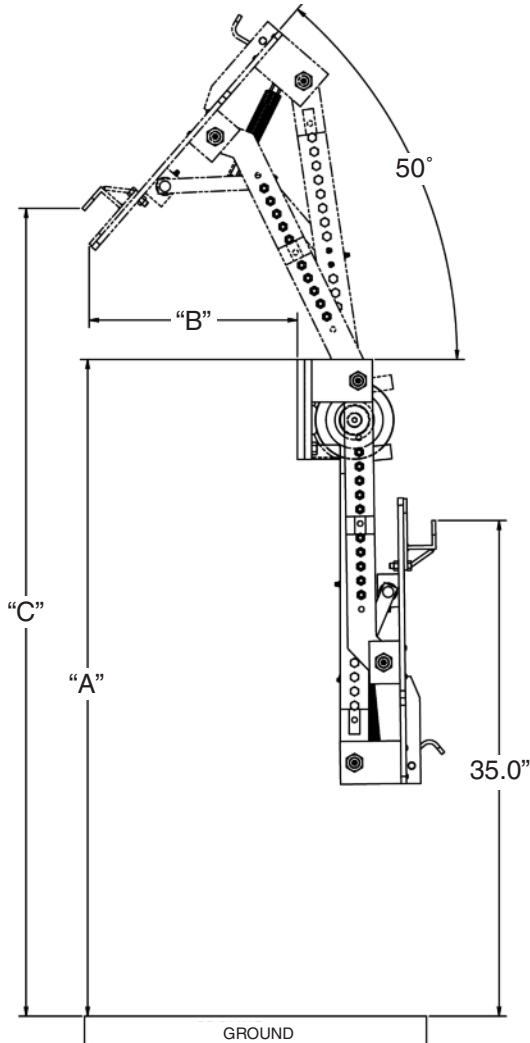

MODEL 450		
"A"	"B"	"C"
45"	14"	55.25"
48"	14.5"	55.25"
50"	14.5"	70"

MODEL 450-HL		
"A"	"B"	"C"
51"	14.5"	72"
54"	14.75"	74.25"
56"	18"	81"

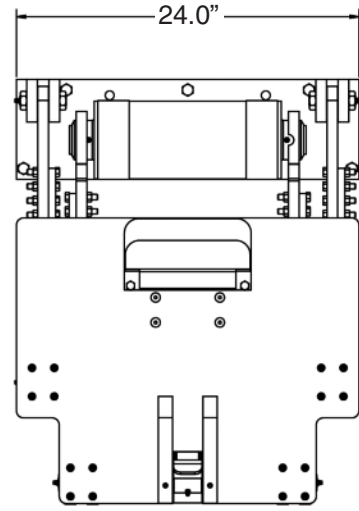

KEY FEATURES AND PERFORMANCE SPECS

- Fits all ANSI Z245.30 (domestic two bar style) Carts & meets all Z245.60 Cart Specifications
- Dumps 400 lbs @ 2000 psi
- 6-8 sec cycle time at 3.2 gpm
- 50 degree Dump angle
- Adjustable mounting height 42" to 55" (mounting plate included)
- Heat treated pivot pins
- 3/8" thick faceplate
- Powder coated finish
- Two year limited warranty